

976nm~980nm 15W Laser Diode with E-mount Package | FAC Optional
980nm High Power 15W LD | Square Beam Optional
RWSLD-980-015-E

980nm Laser Diode		15W/E-mount	
Reverse Voltage	V_r	2.0	V
Operating Temperature	T_{op}	+10 ~+30	°C
Storage Temperature	T_{stg}	-20~ +80	°C
Lead soldering temperature (10 sec.)	T_{is}	260	°C
Features: <ul style="list-style-type: none"> ● 976nm ● CW ● E-mount Package 			
Applications: <ul style="list-style-type: none"> ● Medical Laser Treatment ● Laser Pumping ● Other 			
Specifications	RWSLD-980-015-E		
	Min	Type	Max
Center Wavelength@25°C	976nm+/-10nm		
Spectral Width (FWHM)	----	4.0nm	----
Output Power	----	15W	----
Emitter Area	100x1μm		
Beam Divergence (FWHM)	----	30° _⊥ x 8° _{//}	----
Temperature Coefficient of Wavelength	----	0.3nm / °C	----
Slope Efficiency	----	1.0W/A	----
Threshold Current (Typ.)	----	0.8A	----
Operating Current (Typ.)	----	16.0A	----
Operating Voltage	----	1.9V	----
Package Style	E-mount		
Recommended Operating Temperature	25°C		

E-mount Package View

mm

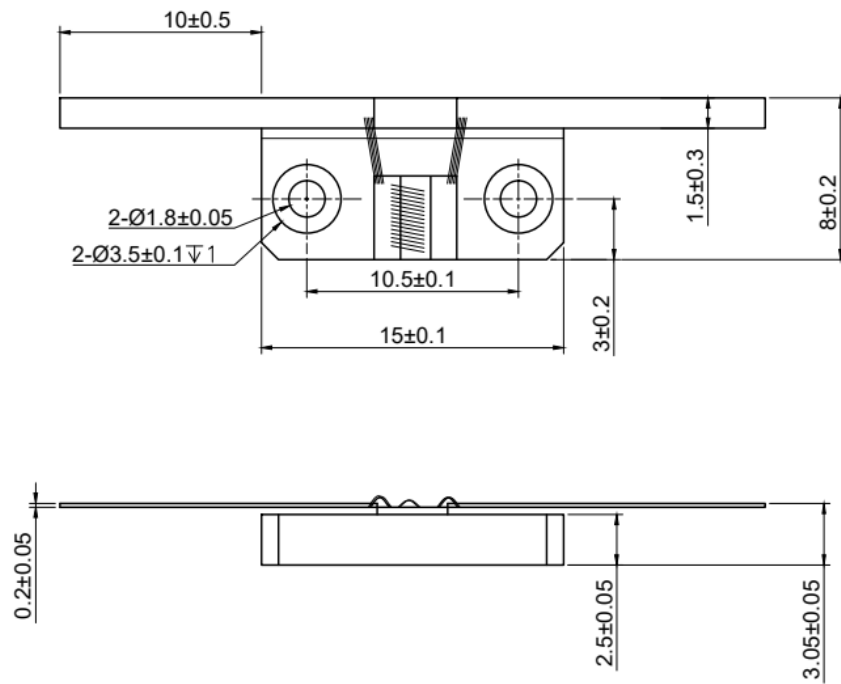

**Electrically shorten LD module and store in non-extreme conditions.
Suggest using the constant current power supply.**

