

**505nm~510nm 30mW Coaxial Pigtailed Diode Laser with MMF | Green LD Module**  
**500nm~505nm Fiber Coupled Laser Diode with 50um 60um 105um Multi-mode Fiber**  
**RWLP-505-030m-M**

505nm Pigtailed Diode Laser		30mW/MM Fiber	
PARAMETER	SYMBOL	VALUE	UNIT
Reverse Voltage	$V_r$	2.0	V
Operating Temperature	$T_{op}$	-10~+60	°C
Storage Temperature	$T_{stg}$	-40~+85	°C
Lead soldering temperature (10 sec.)	$T_{is}$	260	°C
<b>Features:</b> <ul style="list-style-type: none"> <li>● 505nm</li> <li>● Multi-mode Fiber</li> <li>● Coaxial or B82 Package</li> </ul>			
<b>Applications:</b> <ul style="list-style-type: none"> <li>● Medical Laser Treatment</li> <li>● Others</li> </ul>			
<b>Specifications</b>	<b>RWLP-505-030m-M</b>		
	Min	Type	Max
Center Wavelength@25°C	505nm±10nm		
Spectral Width (FWHM)	----	2.0nm	----
Output Power	----	30mW	----
Fiber Core	105um		
Recommended Operating Temperature	25°C		
Monitor Current	----	----	----
PD Reverse Voltage	----	----	----
Fiber Connector	FC/SC/SMA905		
Fiber Length	>80cm		
Threshold Current (Typ.)	----	50mA	90mA
Operating Current (Typ.)	----	180mA	200mA
Operating Voltage	----	7.5V	8.0V
Package Style	Coaxial or B82		

**Coaxial Package View: (Part Number: RWLP-505-030m-M)**

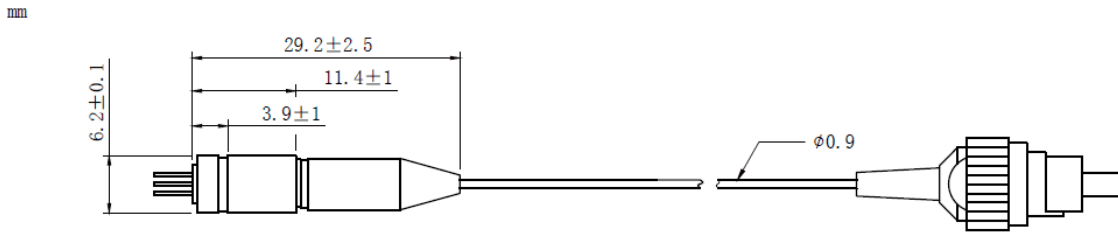

**B82 Package View: (Part Number: RWLP-505-030m-M-B)**

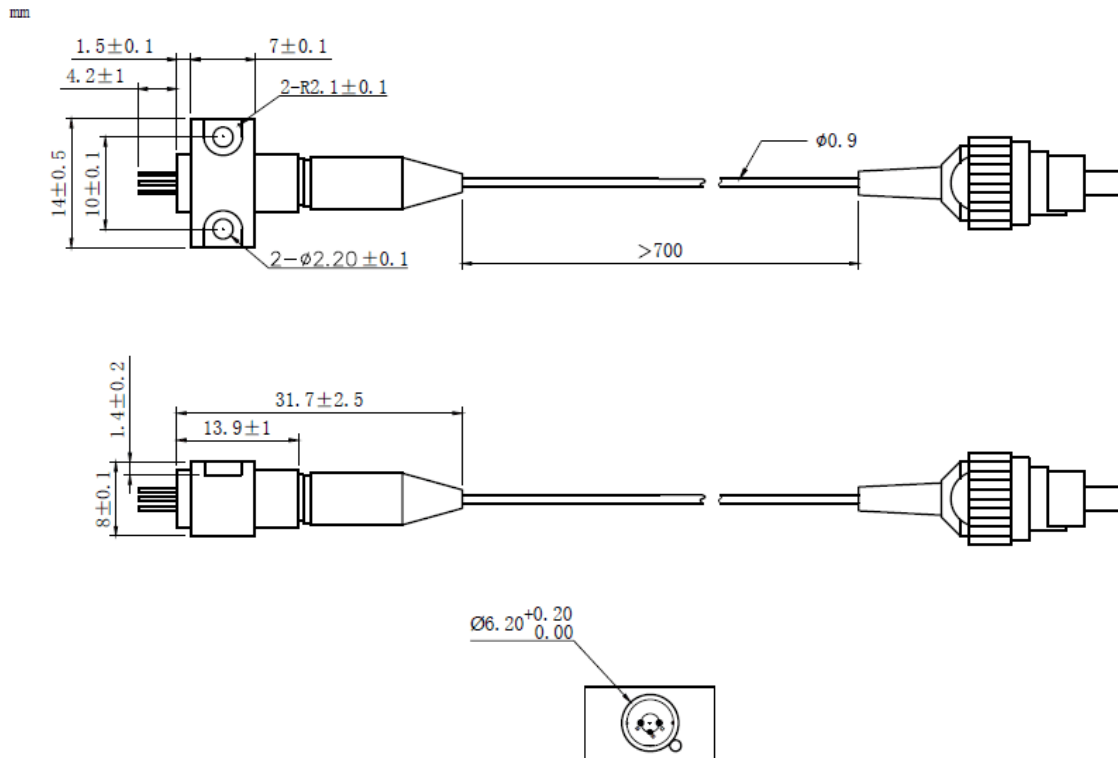

**PIN Bottom View:**

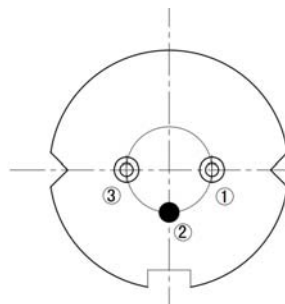

1	LD(+)
2	GND
3	LD(-)

Electrically shorten LD module and store in non-extreme conditions.  
Suggest using the constant current power supply.

