

**520nm 10mW SM Coaxial Fiber Coupled Laser Diode with SMF | Built-in Photodiode**  
**515nm~520nm~530nm SM Pigtailed Green LD with Single Mode Fiber (SM Fiber) | With PD**  
**RWLP-520-010m-4-PD**

520nm Pigtailed Diode Laser		10mW/SMF	
PARAMETER	SYMBOL	VALUE	UNIT
Reverse Voltage	$V_r$	2.0	V
Operating Temperature	$T_{op}$	-20 ~ +60	°C
Storage Temperature	$T_{stg}$	-40 ~ +85	°C
Lead soldering temperature (10 sec.)	$T_{is}$	260	°C
<b>Features:</b> <ul style="list-style-type: none"> <li>🔸 520nm Green Diode Laser</li> <li>🔸 3um SM Fiber</li> <li>🔸 Coaxial or B82 Package</li> <li>🔸 Built-in Photodiode</li> </ul>			
<b>Applications:</b> <ul style="list-style-type: none"> <li>🔸 Medical Laser Treatment</li> <li>🔸 Others</li> </ul>			
<b>Specifications</b>	<b>RWLP-520-010m-4-PD</b>		
	Min	Type	Max
Center Wavelength@25°C	+/-5nm	520nm	+/-10nm
Spectral Width (FWHM)	----	2.0nm	----
Output Power	----	10mW	----
Fiber Type	Single Mode Fiber		
Fiber Core	3um		
PD Current	100uA		
Recommend Operating Temperature	25°C		
Fiber Connector	FC/SC/SMA905		
Fiber Length	----	80cm	100cm
Threshold Current	----	40mA	85mA
Operating Current	----	180mA	200mA
Operating Voltage	----	7.5V	8.0V
Package Style	Coaxial or B82		
Photodiode	Built-in		

**Coaxial Package View: (Part Number: RWLP-520-010m-4-PD)**

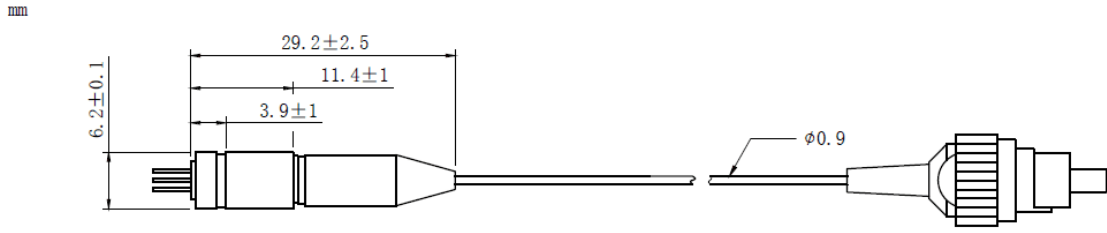

**B82 Package View: (Part Number: RWLP-520-010m-4-B-PD)**

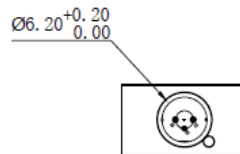
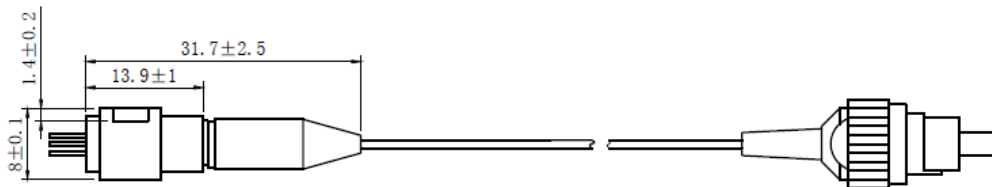
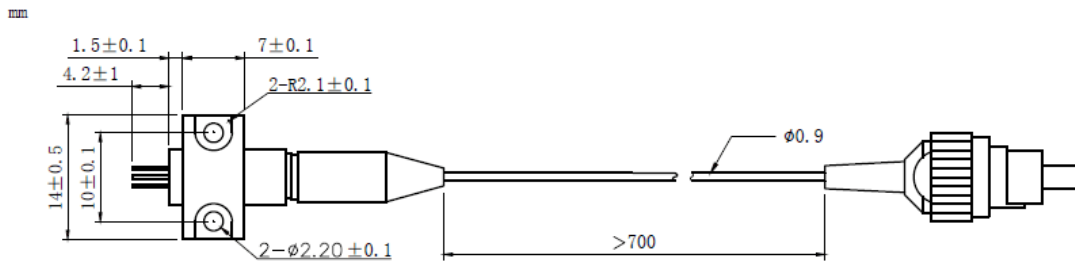

**PIN Bottom View:**

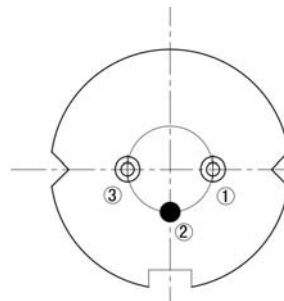

1	LD(-)
2	LD(+)&PD(-)
3	PD(+)

Electrically shorten LD module and store in non-extreme conditions.  
Suggest using the constant current power supply.

