

520nm 30mW Coaxial Diode Laser with Polarization Maintaining Fiber| Built-in Photodiode
515nm~520nm~530nm 30mW PM Fiber Coupled Green LD with SMF | With PD
RWLP-520-030m-PM-PD

| 520nm Pigtailed Diode Laser | | 30mW/PMF | |
|--|--|-----------|-------|
| PARAMETER | SYMBOL | VALUE | UNIT |
| Reverse Voltage | V_r | 2.0 | V |
| Operating Temperature | T_{op} | -20 ~ +60 | °C |
| Storage Temperature | T_{stg} | -40 ~ +85 | °C |
| Lead soldering temperature (10 sec.) | T_{is} | 260 | °C |
| Features: <ul style="list-style-type: none"> ● 520nm Green Diode Laser ● PM Fiber ● High Reliability ● High Polarization Extinction Ratio |  | | |
| Applications: <ul style="list-style-type: none"> ● Biological Instruments ● Analytical Equipment ● Others | | | |
| Specifications | RWLP-520-030m-PM-PD | | |
| | Min | Type | Max |
| Center Wavelength@25°C | 510nm | 520nm | 530nm |
| Spectral Width (FWHM) | ---- | 2.0nm | ---- |
| Output Power | ---- | 30mW | ---- |
| Fiber Type | Polarization Maintaining Fiber | | |
| Fiber Core | 3um | | |
| Polarization Extinction Ratio | 13dB | 15dB | ---- |
| Recommend Operating Temperature | 25°C | | |
| Fiber Connector | FC/APC | | |
| Fiber Length | ---- | 80cm | 100cm |
| Threshold Current | ---- | 40mA | 90mA |
| Operating Current | ---- | 230mA | 250mA |
| Operating Voltage | ---- | 7.5V | 8.0V |
| Photodiode | Built-in | | |
| Package Style | Coaxial or B82 | | |
| High Polarization Extinction Ratio (PER) Version Laser Module is also available, please contact us. | | | |

Coaxial Package View: (Part Number: RWLP-520-030m-PM-PD)

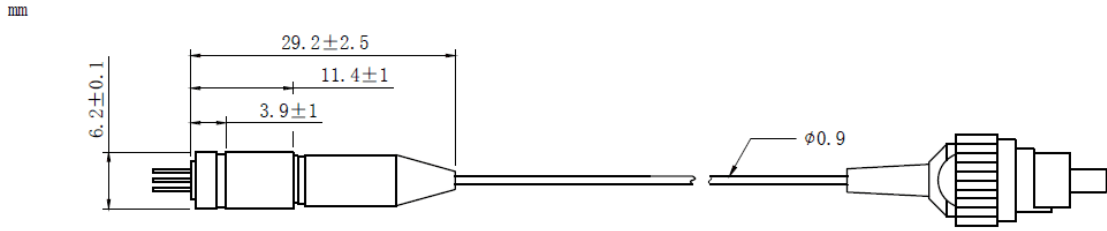

B82 Package View: (Part Number: RWLP-520-030m-PM-B-PD)

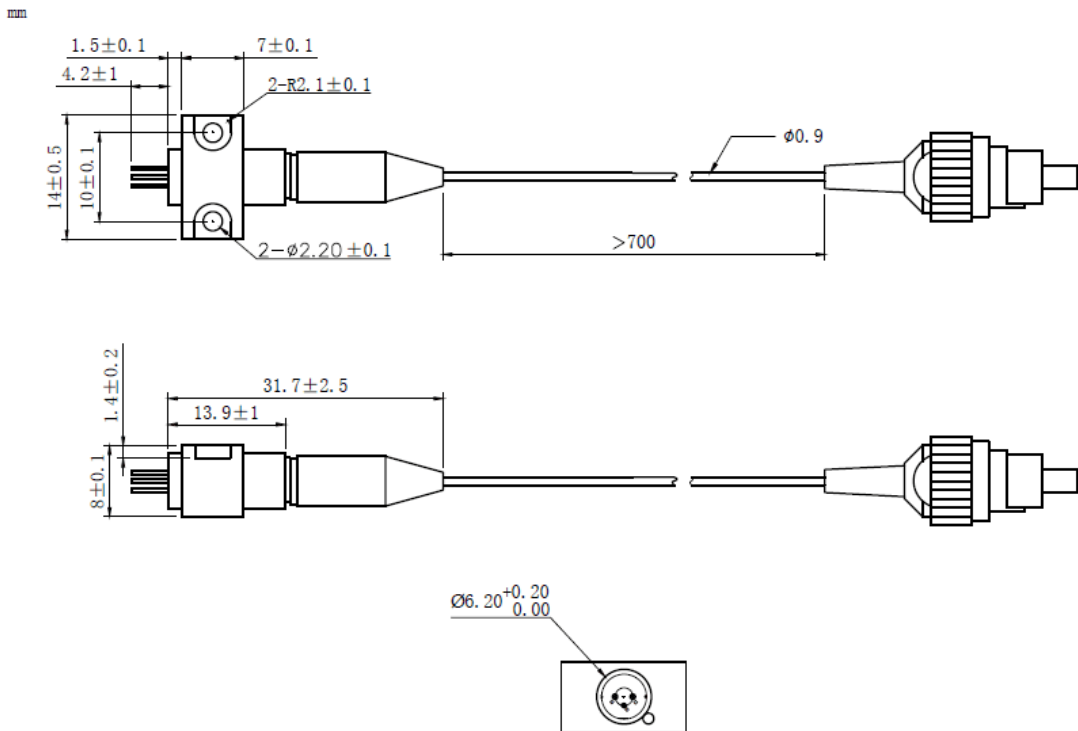

PIN Bottom View:

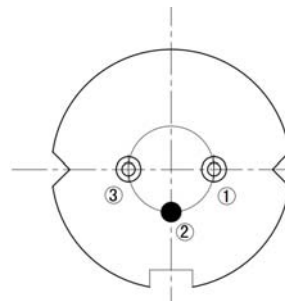

| | |
|---|-------------|
| 1 | LD(-) |
| 2 | LD(+)&PD(-) |
| 3 | PD(+) |

Electrically shorten LD module and store in non-extreme conditions.
Suggest using the constant current power supply.

