

635nm 10mW Fiber Coupled LD with SMF-28 Fiber (9um Fiber Core) | Built-in Photodiode
635nm~638nm 10mW Coaxial Pigtail Laser Diode with 9um Fiber| Built-in PD
RWLP-635-010m-9-PD

| 635nm Pigtailed Diode Laser | | 10mW/9um | |
|--|--|----------|-------|
| PARAMETER | SYMBOL | VALUE | UNIT |
| Reverse Voltage | V_r | 2.0 | V |
| Operating Temperature | T_{op} | -10~+50 | °C |
| Storage Temperature | T_{stg} | -40~+85 | °C |
| Lead soldering temperature (10 sec.) | T_{is} | 260 | °C |
| Features: <ul style="list-style-type: none"> 🔸 635nm 🔸 9um Fiber 🔸 Coaxial or B82 Package 🔸 Built-in PD |  | | |
| Applications: <ul style="list-style-type: none"> 🔸 Medical Laser Treatment 🔸 Aiming Beam 🔸 Others | | | |
| Specifications | RWLP-635-010m-9-PD | | |
| | Min | Type | Max |
| Center Wavelength@25°C | 630nm | 638nm | 645nm |
| Recommended work Temperature | 25°C | | |
| Output Power | ----- | 10mW | ----- |
| Fiber Type | SMF-28 | | |
| Fiber Core | 9um | | |
| Monitor Current | ---- | 0.2mA | ---- |
| PD Reverse Voltage | ---- | ---- | 30V |
| Fiber Connector | FC/SC/SMA905 | | |
| Fiber Length | ---- | 80cm | 100cm |
| Threshold Current | ---- | 45mA | 65mA |
| Operating Current | ---- | 70mA | 80mA |
| Operating Voltage | ---- | 2.5V | 3.0V |
| Package Style | Coaxial or B82 | | |
| Photodiode | Built-in | | |

Coaxial Package View: (Part number: RWLP-635-010m-9-PD)



B82 Package View: (Part number: RWLP-635-010m-9-B-PD)

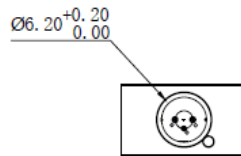

PIN Bottom View:

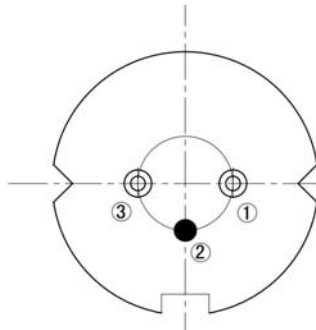

| | |
|---|-------------|
| 1 | LD(-) |
| 2 | LD(+)&PD(-) |
| 3 | PD(+) |

Electrically shorten LD module and store in non-extreme conditions.
Suggest using the constant current power supply.

