

635nm~638nm 80mW Single Mode Fiber Coupled Diode Laser with Photodiode (PD)
635nm 80mW Coaxial Pigtailed Laser Diode with 4um Single Mode Fiber (SM Fiber)
RWLP-635-080m-4-PD

635nm Pigtailed Diode Laser 80mW/SMF			
PARAMETER	SYMBOL	VALUE	UNIT
Reverse Voltage	V_r	2.0	V
Operating Temperature	T_{op}	-10~+60	°C
Storage Temperature	T_{stg}	-40~+85	°C
Lead soldering temperature (10 sec.)	T_{is}	260	°C
Features: <ul style="list-style-type: none"> ● 635nm ● 4um SM Fiber ● Coaxial or B82 Package ● Built-in PD 			
Applications: <ul style="list-style-type: none"> ● Medical Laser Treatment ● Aiming Beam ● Others 			
Specifications	RWLP-635-080m-4-PD		
	Min	Type	Max
Center Wavelength@25°C	630nm	638nm	645nm
Recommended work Temperature	25°C		
Output Power	----	80mW	----
Fiber Type	Single Mode Fiber		
Fiber Core	4um		
Monitor Current	----	0.3mA	----
PD Reverse Voltage	----	----	30V
Fiber Connector	FC/SC/SMA905		
Fiber Length	----	80cm	100cm
Threshold Current	----	60mA	90mA
Operating Current	----	260mA	280mA
Operating Voltage	----	2.8V	3.5V
Package Style	Coaxial or B82		
PD	Built-in		

Coaxial Package View: (Part Number: RWLP-635-080m-4-PD)

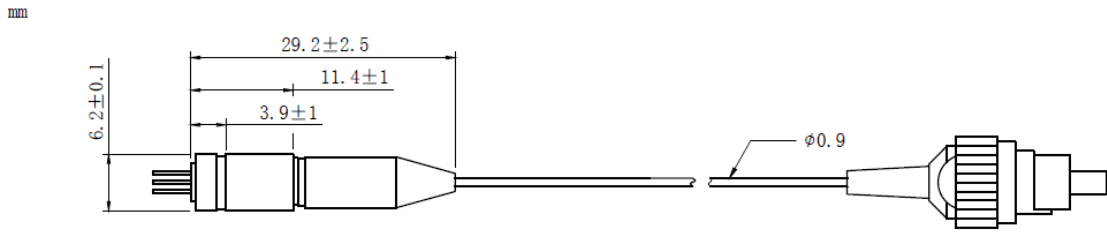

B82 Package View: (Part Number: RWLP-635-080m-4-B-PD)

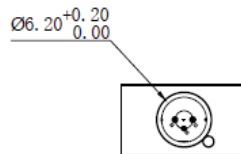
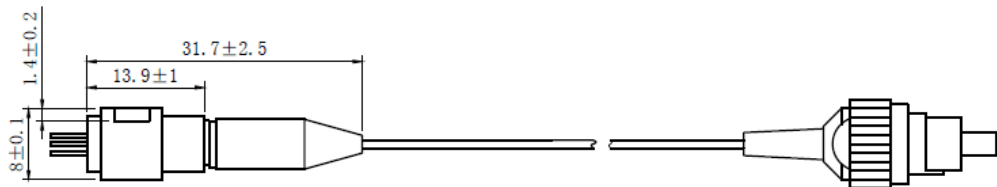
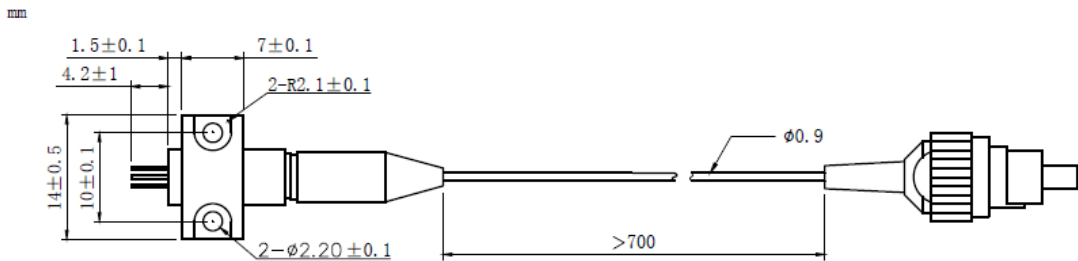

PIN Bottom View:

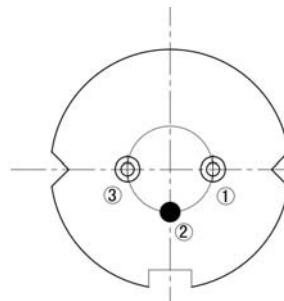

1	LD(-)
2	LD(+)& PD(-)
3	PD(+)

Electrically shorten LD module and store in non-extreme conditions.
Suggest using the constant current power supply.

