

**635nm~638nm 120mW MM Fiber Coupled LD Module | Red Laser Module**

**635nm 120mW~130mW Coaxial Pigtailed Laser Diode with Multi-mode Fiber | With Photodiode  
RWLP-635-120m-M-PD**

635nm Pigtailed Diode Laser		120mW/MM Fiber	
PARAMETER	SYMBOL	VALUE	UNIT
MAX Reverse Voltage	$V_r$	2.0	V
Operating Temperature	$T_{op}$	-10~+60	°C
Storage Temperature	$T_{stg}$	-40~+85	°C
Lead soldering temperature (10 sec.)	$T_{is}$	260	°C
<b>Features:</b> <ul style="list-style-type: none"> <li>• 638nm</li> <li>• MM Fiber</li> <li>• Coaxial or B82 Package</li> </ul>			
<b>Applications:</b> <ul style="list-style-type: none"> <li>• Medical Laser Treatment</li> <li>• Aiming Beam</li> <li>• Others</li> </ul>			
<b>Specifications</b>	<b>RWLP-635-120m-M-PD</b>		
	Min	Type	Max
Center Wavelength@25°C	630nm	638nm	645nm
Recommended work Temperature	25°C		
Output Power	----	120mW	----
Fiber Type	Multi-mode Fiber		
Fiber Core	105um(50um, 62.5um optional)		
Monitor Current	----	0.3mA	----
PD Reverse Voltage	----	----	30V
Fiber Connector	FC/SC/SMA905		
Fiber Length	>80cm		
Threshold Current (Typ.)	----	60mA	90mA
Operating Current (Typ.)	----	260mA	280mA
Operating Voltage	----	2.8V	3.5V
Package Style	Coaxial or B82		

**Coaxial Package View: (Part Number: RWLP-635-120m-M-PD)**

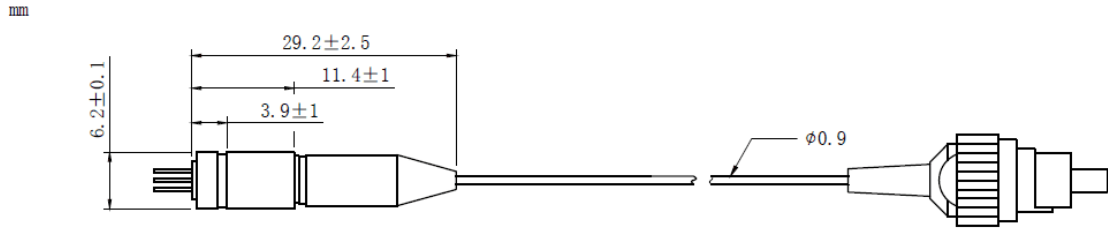

**B82 Package View: (Part Number: RWLP-635-120m-M-B-PD)**

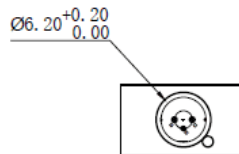
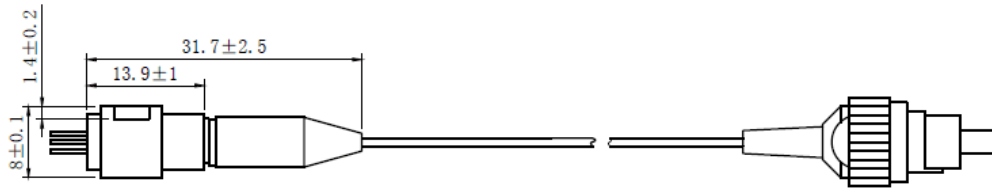
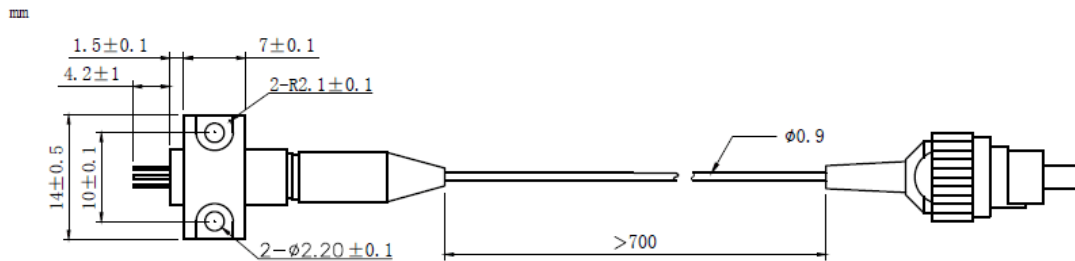

**PIN Bottom View:**

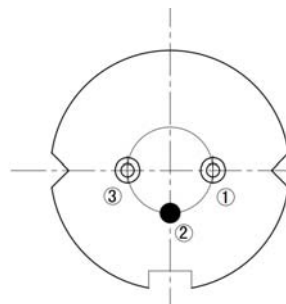

1	LD(-)
2	LD(+)&PD(-)
3	PD(+)

Electrically shorten LD module and store in non-extreme conditions.  
Suggest using the constant current power supply.

