

650nm~660nm 30mW SM Coaxial Pigtailed Laser Diode with PMF | Built-in Photodiodes (PD)

658nm SM Fiber Coupled LD with Polarization Maintaining Fiber |With PD

RWLP-650-030m-PM-PD

658nm Pigtailed Diode Laser		30mW/PM Fiber	
PARAMETER	SYMBOL	VALUE	UNIT
Reverse Voltage	V_r	2.0	V
Operating Temperature	T_{op}	-10~+60	°C
Storage Temperature	T_{stg}	-40~+85	°C
Lead soldering temperature (10 sec.)	T_{is}	260	°C
Features: <ul style="list-style-type: none"> ● 658nm ● 4um PM Fiber ● High Reliability ● High Polarization Extinction Ratio 			
Applications: <ul style="list-style-type: none"> ● Medical Laser Treatment ● Others 			
Specifications	RWLP-650-030m-PM-PD		
	Min	Type	Max
Center Wavelength@25°C	650nm	658nm	670nm
Recommended Operating Temperature	25°C		
Output Power	----	30mW	----
Fiber Type	Polarization Maintaining Fiber		
Fiber Core	4um		
Polarization Extinction Ratio	13dB	15dB	----
Monitor Current	----	0.3mA	----
Fiber Length	>80cm		
Threshold Current (Typ.)	----	45mA	70mA
Operating Current (Typ.)	----	120mA	140mA
Operating Voltage	----	2.7V	3.3V
Fiber Connector	FC/APC		
Package Style	Coaxial or B82		
High Polarization Extinction Ratio (PER) Version Laser Module is also available, please contact us.			

Coaxial Package View: (Part Number: RWLP-650-030m-PM-PD)

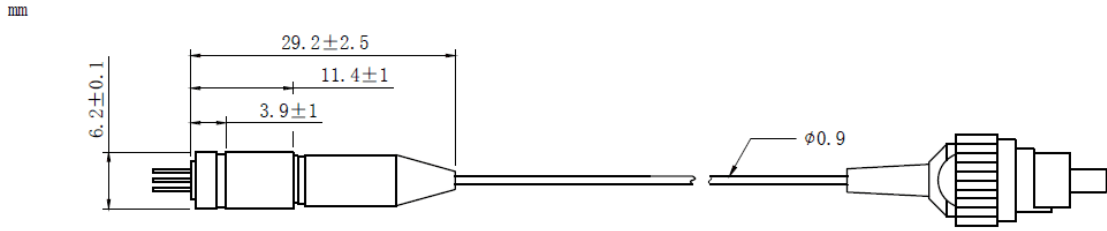

B82 Package View: (Part Number: RWLP-650-030m-PM-B-PD)

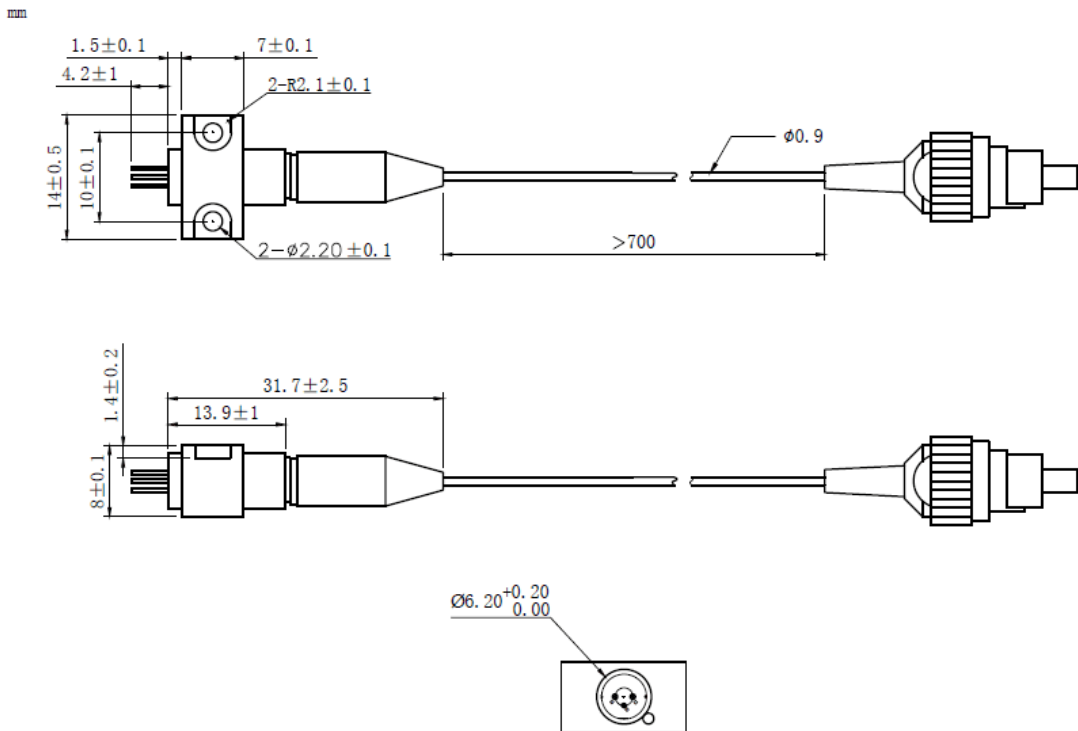

PIN Bottom View:

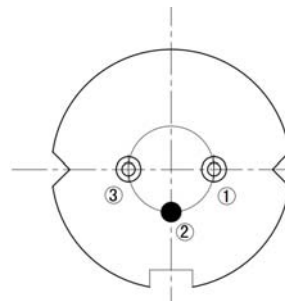

1	LD(-)
2	LD(+)&PD(-)
3	PD(+)

Electrically shorten LD module and store in non-extreme conditions.
Suggest using the constant current power supply.

