

**650nm~660nm 50mW~60mW SM Coaxial Pigtailed Laser Diode with PMF**  
**658nm 50mW SM Fiber Coupled LD with Polarization Maintaining Fiber**  
**RWLP-650-050m-PM**

658nm Pigtailed Diode Laser		50mW/PM Fiber	
PARAMETER	SYMBOL	VALUE	UNIT
Reverse Voltage	$V_r$	2.0	V
Operating Temperature	$T_{op}$	-10~+60	°C
Storage Temperature	$T_{stg}$	-40~+85	°C
Lead soldering temperature (10 sec.)	$T_{is}$	260	°C
<b>Features:</b> <ul style="list-style-type: none"> <li>650nm</li> <li>4um PM Fiber</li> <li>High Stability</li> <li>High Polarization Extinction Ratio</li> </ul>			
<b>Applications:</b> <ul style="list-style-type: none"> <li>Medical Laser Treatment</li> <li>Others</li> </ul>			
<b>Specifications</b>	<b>RWLP-650-050m-PM</b>		
	Min	Type	Max
Center Wavelength@25°C	±5nm	658nm	±10nm
Recommended Operating Temperature	25°C		
Output Power	----	50mW	----
Fiber Type	Polarization Maintaining Fiber		
Fiber Core	4um		
Polarization Extinction Ratio	13dB	15dB	
Fiber Length	----	80cm	100cm
Threshold Current	----	55mA	80mA
Operating Current	----	210mA	230mA
Operating Voltage	----	2.8V	3.5V
Fiber Connector	FC/APC		
Package Style	Coaxial or B82		
High Polarization Extinction Ratio (PER) Version Laser Module is also available, please contact us.			

**Coaxial Package View: (Part Number: RWLP-650-050m-PM)**

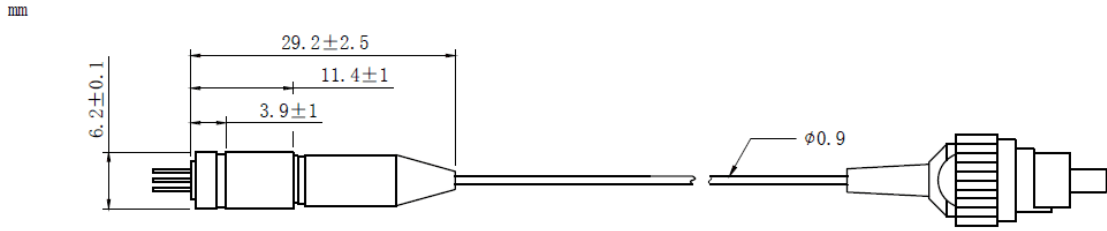

**B82 Package View: (Part Number: RWLP-650-050m-PM-B)**

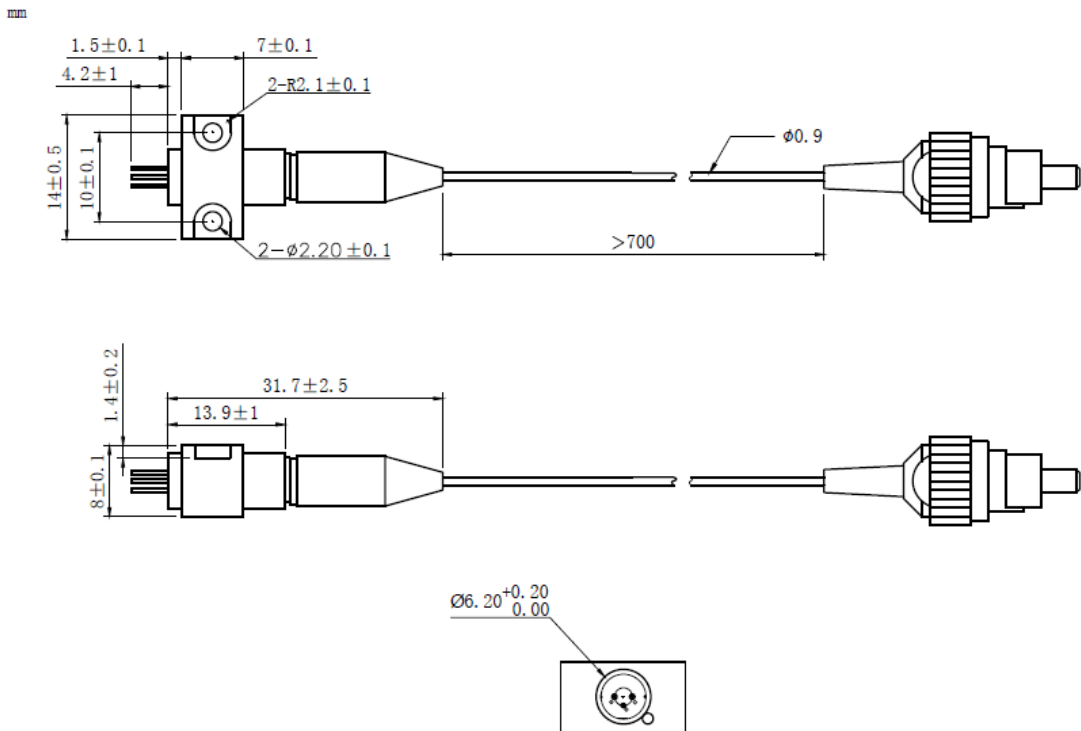

**PIN Bottom View:**

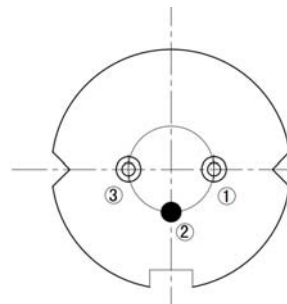

1	LD(+)
2	LD(-)
3	NC

Electrically shorten LD module and store in non-extreme conditions.  
Suggest using the constant current power supply.

