

**660nm 120mW~130mW Multi-mode Fiber Coupled Diode Laser | Red LD Module**  
**658nm~660nm 120mW Coaxial Pigtailed Laser Diode with MMF | 62.5um, 105um Fiber Optional**  
**RWLP-660-120m-M**

660nm Pigtailed Diode Laser		120mW/MM Fiber	
PARAMETER	SYMBOL	VALUE	UNIT
Reverse Voltage	$V_r$	2.0	V
Operating Temperature	$T_{op}$	-10~+50	°C
Storage Temperature	$T_{stg}$	-40~+85	°C
Lead soldering temperature (10 sec.)	$T_{is}$	260	°C
<b>Features:</b> <ul style="list-style-type: none"> <li>● 660nm</li> <li>● MM Fiber</li> <li>● Coaxial or B82 Package</li> </ul>			
<b>Applications:</b> <ul style="list-style-type: none"> <li>● Medical Laser Treatment</li> <li>● Aiming Beam</li> <li>● Others</li> </ul>			
<b>Specifications</b>	<b>RWLP-660-120m-M</b>		
	Min	Type	Max
Center Wavelength@25°C	660nm±10nm		
Recommended work Temperature	25°C		
Output Power	----	120mW	----
Fiber Type	Multi-mode Fiber		
Fiber Core	105um (50um, 62.5um Optional)		
Monitor Current	----	----	----
PD Reverse Voltage	----	----	----
Fiber Connector	FC/SC/SMA905		
Fiber Length	>80cm		
Threshold Current (Typ.)	----	55mA	85mA
Operating Current (Typ.)	----	220mA	240mA
Operating Voltage	----	2.8V	3.5V
Package Style	Coaxial or B82		

**Coaxial Package View: (Part Number: RWLP-660-120m-M)**

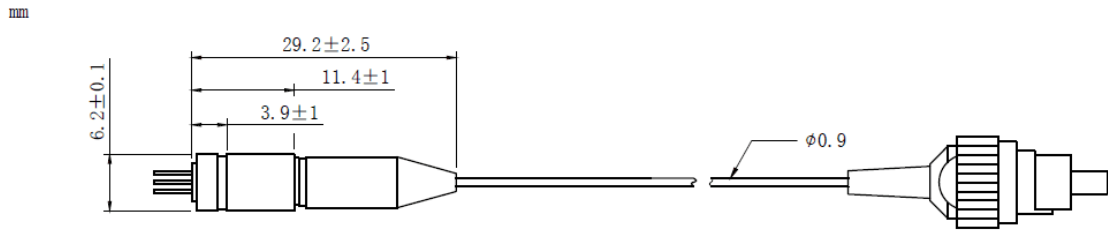

**B82 Package View: (Part Number: RWLP-660-120m-M-B)**

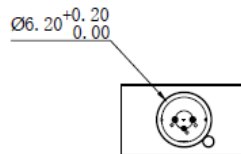
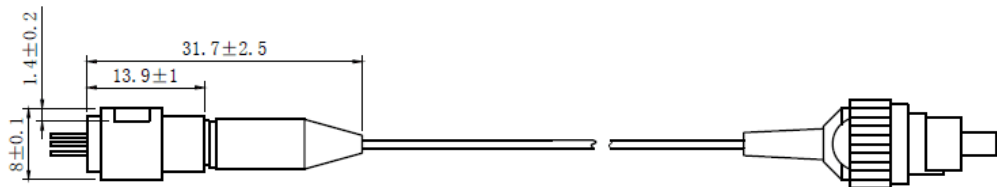
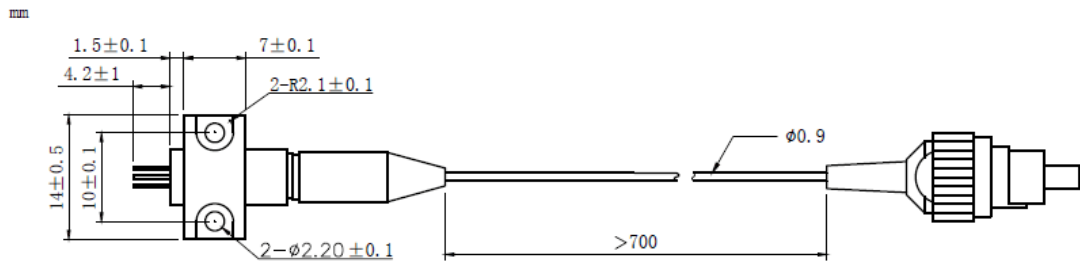

**PIN Bottom View:**

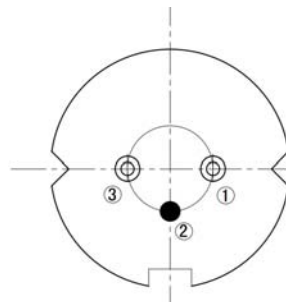

1	LD(+)
2	LD(-)
3	NC

Electrically shorten LD module and store in non-extreme conditions.

Suggest using the constant current power supply.

