

**670nm 3mW SM Coaxial Pigtailed Laser Diode with SMF | 4um SMF| Built-in Photodiode| Heat-sink Optional**  
**670nm~675nm SM Fiber Coupled LD with Single Mode Fiber | With PD | Single Mode Beam**  
**RWLP-670-003m-4-PD**

670nm Pigtailed Diode Laser 3mW/SMF			
PARAMETER	SYMBOL	VALUE	UNIT
Reverse Voltage	$V_r$	2.0	V
Operating Temperature	$T_{op}$	-10 ~ +60	°C
Storage Temperature	$T_{stg}$	-40 ~ +85	°C
Lead soldering temperature (10 sec.)	$T_{is}$	260	°C
<b>Features:</b> <ul style="list-style-type: none"> <li>• 670nm</li> <li>• With SM Fiber</li> <li>• Coaxial or B82 Package</li> <li>• Built-in PD</li> </ul>			
<b>Applications:</b> <ul style="list-style-type: none"> <li>• Medical Laser Treatment</li> <li>• Others</li> </ul>			
<b>Specifications</b>	<b>RWLP-670-003m-4-PD</b>		
	Min	Type	Max
Center Wavelength@25°C	±5nm	670nm	±10nm
Recommended Operating Temperature	25°C		
Output Power	----	3mW	----
Fiber Type	Single Mode Fiber		
Fiber Core	4um		
Monitor Current	----	0.5mA	----
PD Reverse Voltage	----	----	30V
Fiber Connector	FC/SC/SMA905		
Fiber Length	----	80cm	100cm
Threshold Current (Typ.)	----	20mA	30mA
Operating Current (Typ.)	----	35mA	40mA
Operating Voltage	----	2.3V	2.8V
Package Style	Coaxial or B82		
PD	Built-in		

**Coaxial Package View: (Part Number: RWLP-670-003m-4-PD)**

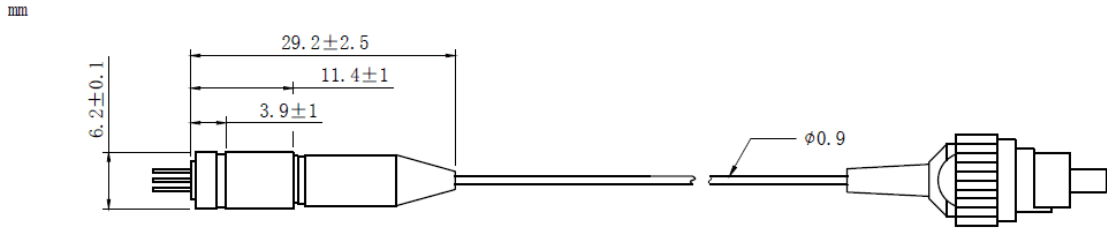

**B82 Package View: (Part Number: RWLP-670-003m-4-B-PD)**

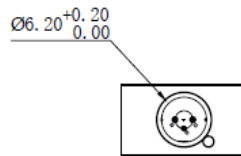
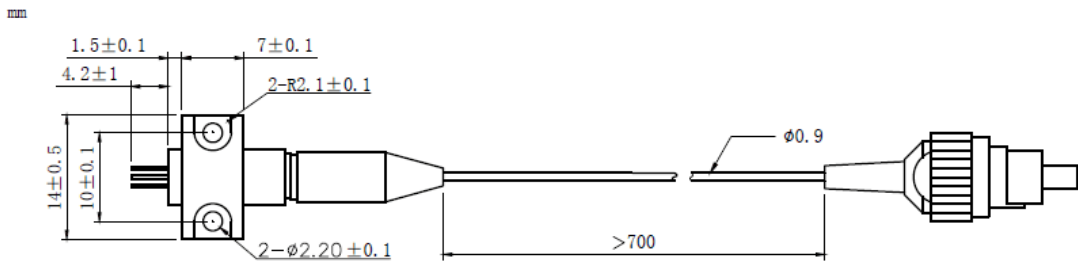

**PIN Bottom View:**

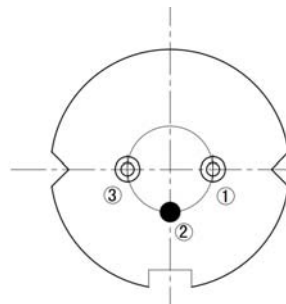

1	LD(-)
2	LD(+)&PD(-)
3	PD(+)

Electrically shorten LD module and store in non-extreme conditions.  
Suggest using the constant current power supply.

