

665nm~670nm 50mW~60mW SM Coaxial Pigtailed Laser Diode with PMF
670nm 50mW SM Fiber Coupled LD with Polarization Maintaining Fiber
RWLP-670-050m-PM

670nm Pigtailed Diode Laser		50mW/PM Fiber	
PARAMETER	SYMBOL	VALUE	UNIT
Reverse Voltage	V_r	2.0	V
Operating Temperature	T_{op}	-10~+60	°C
Storage Temperature	T_{stg}	-40~+85	°C
Lead soldering temperature (10 sec.)	T_{is}	260	°C
Features: <ul style="list-style-type: none"> ● 670nm ● 4um PM Fiber ● High Stability ● High Polarization Extinction Ratio 			
Applications: <ul style="list-style-type: none"> ● Medical Laser Treatment ● Others 			
Specifications	RWLP-670-050m-PM		
	Min	Type	Max
Center Wavelength@25°C	670nm±10nm		
Recommended Operating Temperature	25°C		
Output Power	----	50mW	----
Fiber Type	Polarization Maintaining Fiber		
Fiber Core	4um		
Polarization Extinction Ratio	13dB	15dB	
Fiber Length	>80cm		
Threshold Current	----	55mA	80mA
Operating Current	----	210mA	230mA
Operating Voltage	----	2.8V	3.5V
Fiber Connector	FC/APC		
Package Style	Coaxial or B82		
High Polarization Extinction Ratio (PER) Version Laser Module is also available, please contact us.			

Coaxial Package View: (Part Number: RWLP-670-050m-PM)



B82 Package View: (Part Number: RWLP-670-050m-PM-B)

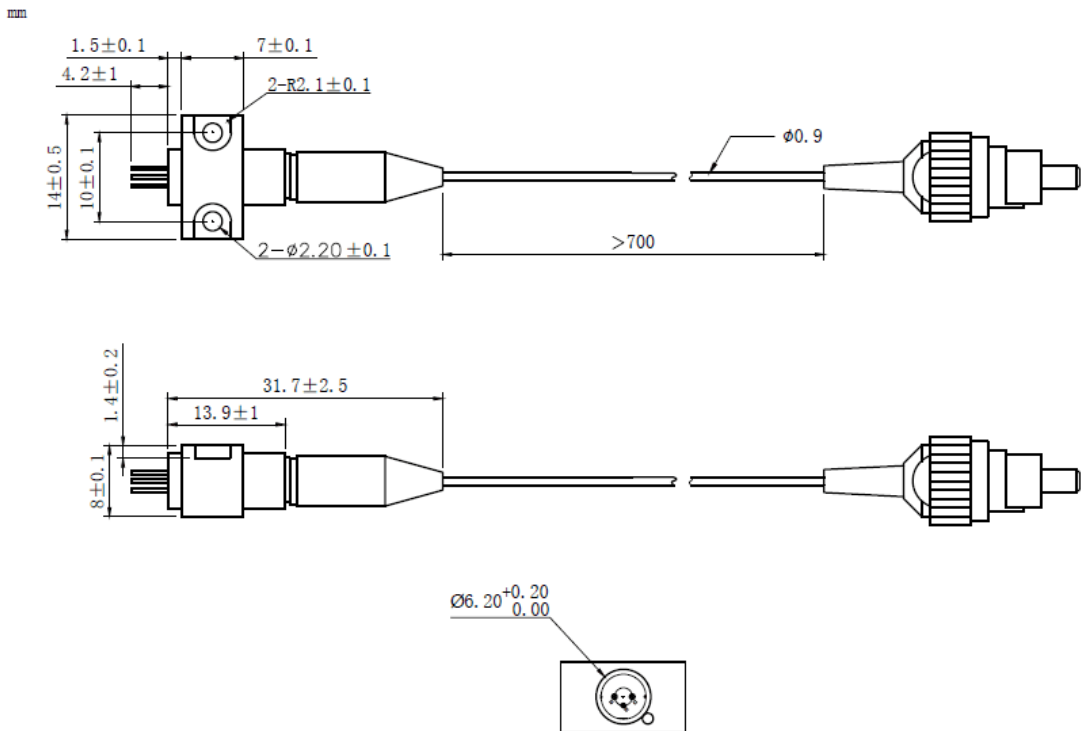

PIN Bottom View:

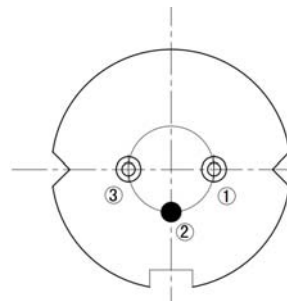

1	LD(+)
2	LD(-)
3	NC

Electrically shorten LD module and store in non-extreme conditions.
Suggest using the constant current power supply.

