

905nm 1mW~2mW SM Coaxial Pigtailed Laser Diode with SMF | Built-in Photodiode
905nm~915nm 2mW SM Fiber Coupled LD with Single Mode Fiber (SM Fiber) | With PD
RWLP-905-002m-4-PD

905nm Pigtailed Diode Laser		2mW/SM Fiber	
PARAMETER	SYMBOL	VALUE	UNIT
Reverse Voltage	V_r	2.0	V
Operating Temperature	T_{op}	-10~+60	°C
Storage Temperature	T_{stg}	-40~+85	°C
Lead soldering temperature (10 sec.)	T_{is}	260	°C
Features: <ul style="list-style-type: none"> ● 905nm ● SM Fiber ● Coaxial or B82 Package ● Built-in PD 			
Applications: <ul style="list-style-type: none"> ● Medical Laser Treatment ● Sensor ● Others 			
Specifications	RWLP-905-002m-4-PD		
	Min	Type	Max
Center Wavelength@25°C	±10nm	905nm	±20nm
Recommended Operating Temperature	25°C		
Output Power	1mW	2mW	---
Fiber Type	Single Mode Fiber		
Fiber Core	5um		
Monitor Current	---	0.2mA	---
PD Reverse Voltage	---	---	30V
Fiber Connector	FC/SC/SMA905		
Fiber Length	---	80cm	100cm
Threshold Current (Typ.)	---	10mA	25mA
Operating Current (Typ.)	---	35mA	50mA
Operating Voltage	---	1.8V	2.4V
Package Style	Coaxial or B82		
Photodiodes	Built-in		

Coaxial Package View: (Part Number: RWLP-905-002m-4-PD)



B82 Package View: (Part Number: RWLP-905-002m-4-B-PD)

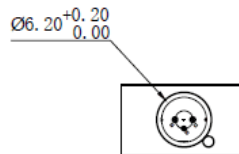

PIN Bottom View:

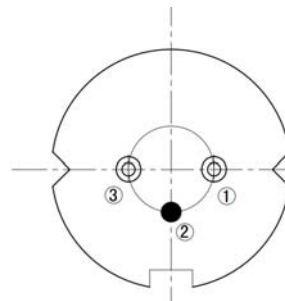

1	LD(-)
2	LD(+)&PD(-)
3	PD(+)

Electrically shorten LD module and store in non-extreme conditions.
Suggest using the constant current power supply.

